

T905



◆ 特点与用途/Features & Applications

- 用于卸扣的销轴传感器
- 不锈钢/合金钢材料
- 外形尺寸小，操作安装方便
- Pin sensor which used together with shackle
- Stainless steel or alloy steel material
- Small size, easy operation and installation

◆ 安装尺寸/Mounting Dimension

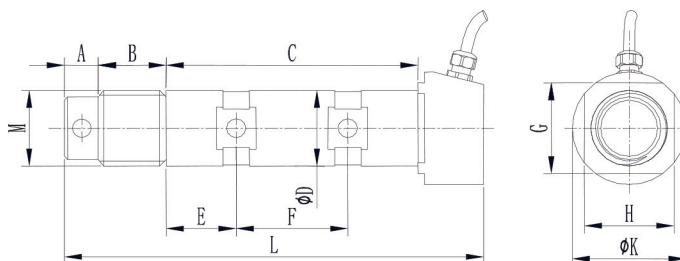

Cap (t)	A	B	C	D	E	F
6.5	10	22.5	80	25	22	36
12	15	31.5	115	35	32	51
25	20	46	165	50.8	46	73
55	25	63	235	70	65	105

Cap (t)	G	H	K	M
6.5	34	34	34	1" × 8 tpi UNC
12	41	41	41	1-3/8" × 6 tpi UNC
25	54	54	54	2" × 4.5 tpi UNC
55	74	74	74	2-3/4" × 4 tpi UNC

◆ 参数 Specifications 技术指标/Technique

额定容量	Capacity	6.5,12,25,55t
输出灵敏度	Sensitivity	1.2~1.5mV/V
零点输出	Zero balance	±0.03 mV/V
非线性	Non-linearity	0.5%F.S.
滞后	Hysteresis	0.2%F.S.
重复性	Repeatability	0.1%F.S.
蠕变 (30min)	Creep(30min)	0.1%F.S.
温度灵敏度漂移	Temp.effect on output	0.05%F.S./10℃
零点温度漂移	Temp.effect on zero	0.05%F.S./10℃
输入电阻	Input impedance	780 ± 20 Ω
输出电阻	Output impedance	700 ± 10 Ω
绝缘电阻	Insulation	≥5000MΩ/100VDC
激励电压	Recommended excitation	5~15V
最大激励电压	Maximum excitation Voltage	20V
温度补偿范围	Compensated temp range	-10~60℃
工作温度范围	Operating temperature range	-20~80℃
安全载荷	Safe load limit	150%F.S.
破坏负载	Breaking load	200%F.S.
电缆线尺寸	Cable size	φ 4 × 4000mm
防护等级	IP Class	IP67

◆ 受力方式/Load Direction

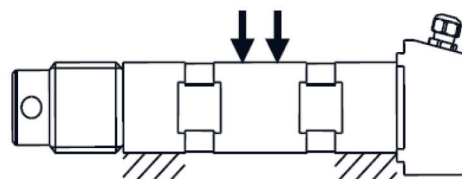

◆ 配线图/Wiring Code

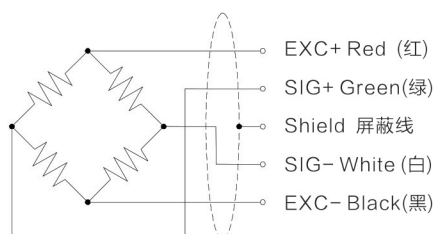

新产品

压向传感器

拉压向传感器

压电力传感器

多维力传感器

称重传感器

张力传感器

螺纹力

扭矩传感器

其它定制力传感器

称重模块

仪表模块放大器